

6X8 1.75x7 HZL DSP TOP PRIV KIT WH

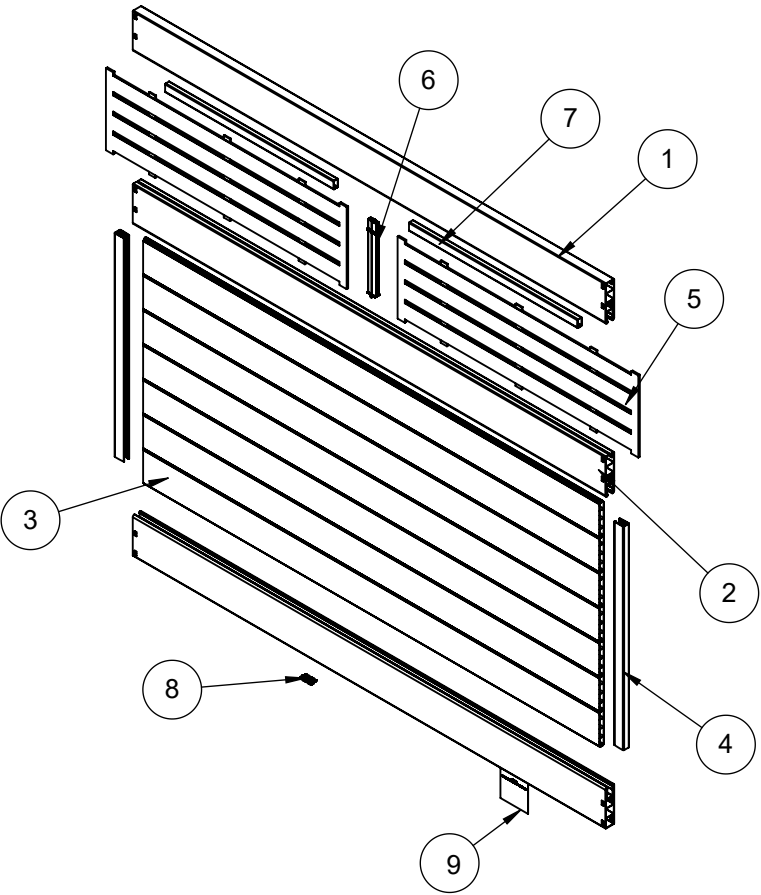

ITEM NO.	DESCRIPTION	
1	1.75x7x94 DECO EXT WHITE	2
2	1.75x7x94 DECO EXT SLIT WHITE	1
3	.875X6X90.75 W/.035W EXTR T&G WHITE	7
4	1.00X1.875X38.625 STR PST CHN EXT WHITE	2
5	~61125017~14.125X47.875 BOARDWALK WHITE	2
6	DSP TOPPER STILE WHITE (2PK)	1
7	~61107126~.875X1.5X33.5 SGL SLIT WHITE	2
8	#10 X 3/4" PAN HEAD SCREW (10 PC)	1
9	GENERIC INSTR CARD VF/VG - PRO/SO 2020	1

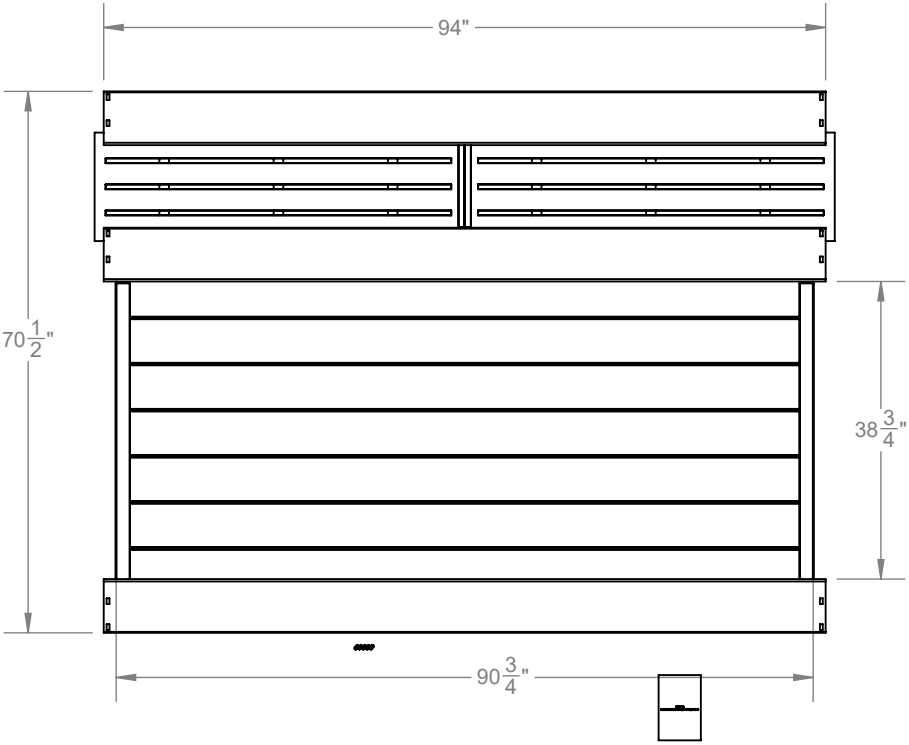

THE INFORMATION CONTAINED IN THIS DRAWING IS PROTECTED BY COPYRIGHT AND PATENT LAWS OF THE UNITED STATES AND OTHER COUNTRIES. ANY REPRODUCTION IN PART OR AS A WHOLE WITHOUT WRITTEN PERMISSION IS PROHIBITED.

# 6X6 1.75x7 HZL DSP TOP PRIV KIT WH

ITEM NO.	DESCRIPTION	
1	1.75X7X70 DECO EXTR WHITE	2
2	1.75X7X70 DECO SLIT WHITE	1
3	.875X6X66.75 .035W EXTR T&G WHITE	7
4	1.00X1.875X38.625 STR PST CHN EXT WHITE	2
5	DSP TOPPER STILE WHITE (2PK)	1
6	~61125017~14.125X34.375 BOARDWALK WHITE	2
7	~61107126~.875X1.5X33.5 SGL SLIT WHITE	2
8	#10 X 3/4" PAN HEAD SCREW (10 PC)	1
9	GENERIC INSTR CARD VF/VG - PRO/SO 2020	1

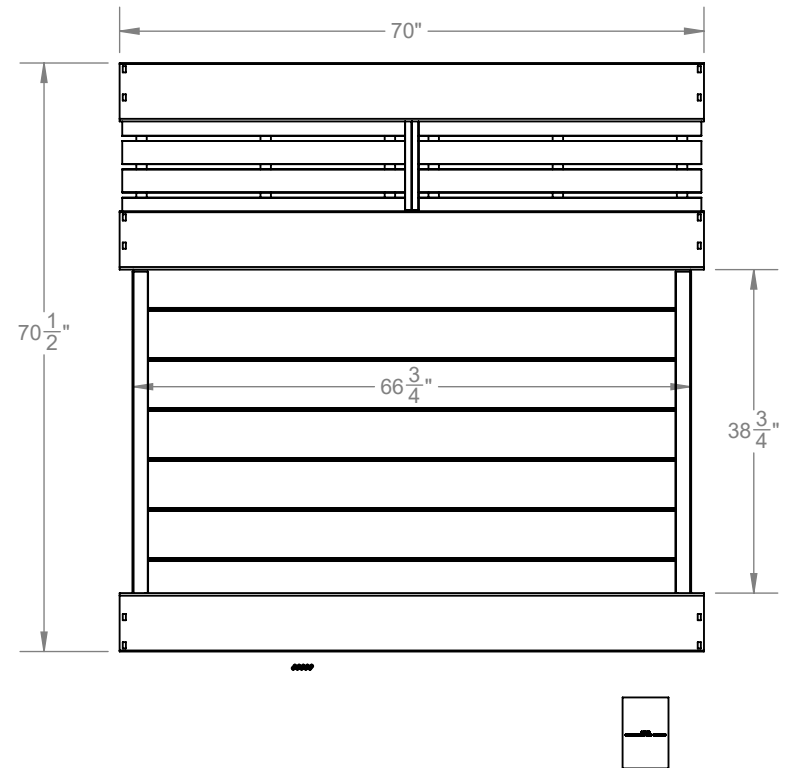
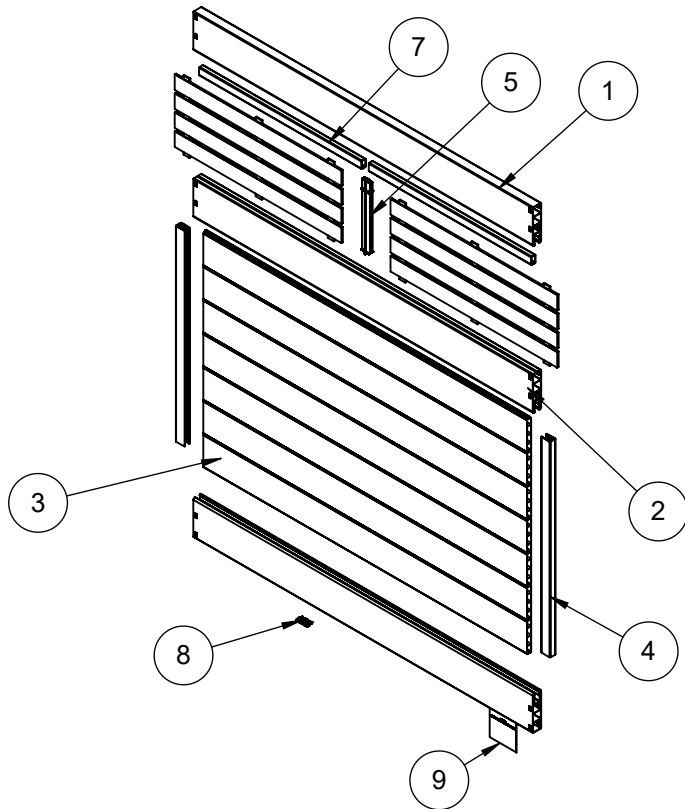

THE INFORMATION CONTAINED IN THIS DRAWING IS PROTECTED BY COPYRIGHT AND PATENT LAWS OF THE UNITED STATES AND OTHER COUNTRIES. ANY REPRODUCTION IN PART OR AS A WHOLE WITHOUT WRITTEN PERMISSION IS PROHIBITED.

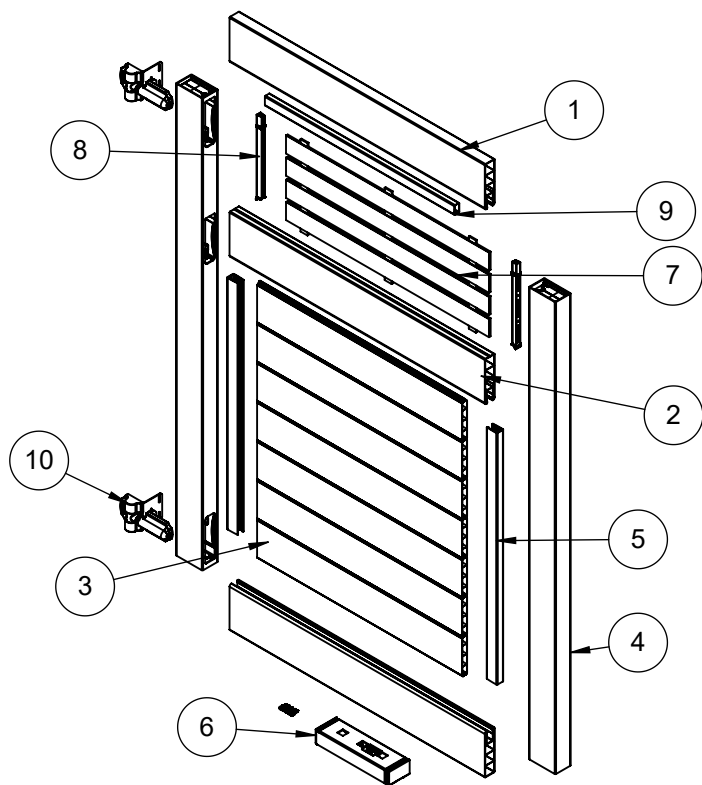

NOTES:  
1. VERIFY GLIDELOCK COVERS ARE INSTALLED AND GLUED TO UPRIGHT PRIOR TO PACKAGING KIT.

6X46 1.75x7 HZL DSP TOP PRIV GT WH

ITEM NO.	DESCRIPTION	QTY
1	1.75x7x45.125 DECO EXT WHITE	2
2	1.75x7x45.125 DECO EXT SLIT WHITE	1
3	.875X6X36.25 W/.035W EXTR T&G WHITE	7
4	2.75X4.70X73.5 1.75X7X3 DSP IGP WHITE	2
5	1.00X1.875X38.625 STR PST CHN EXT WHITE	2
6	2.25X3.875X13.25 PRIV GATE HWBOX-WHITE	1
7	~61125017~14.125X35.875 BOARDWALK WHITE	1
8	DSP TOPPER STILE WHITE (2PK)	1
9	~61107126~.875X1.5X33.5 SGL SLIT WHITE	1
10	HEAVY DUTY HINGE PAIR BLACK	1
11	#10 X 3/4" PAN HEAD SCREW (10 PC)	1

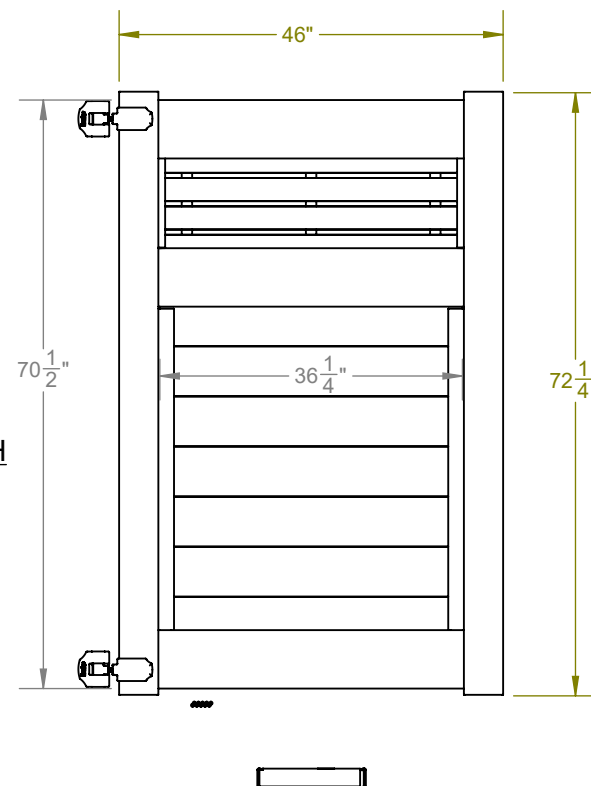

THE INFORMATION CONTAINED IN THIS DRAWING IS PROTECTED BY COPYRIGHT AND PATENT LAWS OF THE UNITED STATES AND OTHER COUNTRIES. ANY REPRODUCTION IN PART OR AS A WHOLE WITHOUT WRITTEN PERMISSION IS PROHIBITED.

ITEM NO.	DESCRIPTION	QTY
1	1.75x7x57.125 DECO EXT WHITE	2
2	1.75x7x57.125 DECO EXT SLIT WHITE	1
3	.875X6X48.25 W/.035W EXTR T&G WHITE	7
4	2.75X4.70X73.5 1.75X7X3 DSP IGP WHITE	2
5	1.00X1.875X38.625 STR PST CHN EXT WHITE	2
6	2.25X3.875X13.25 PRIV GATE HWBOX-WHITE	1
7	~61125017~14.125X47.875 BOARDWALK WHITE	1
8	DSP TOPPER STILE WHITE (2PK)	1
9	~61107126~.875X1.5X33.5 SGL SLIT WHITE	1
10	HEAVY DUTY HINGE PAIR BLACK	1
11	#10 X 3/4" PAN HEAD SCREW (10 PC)	1

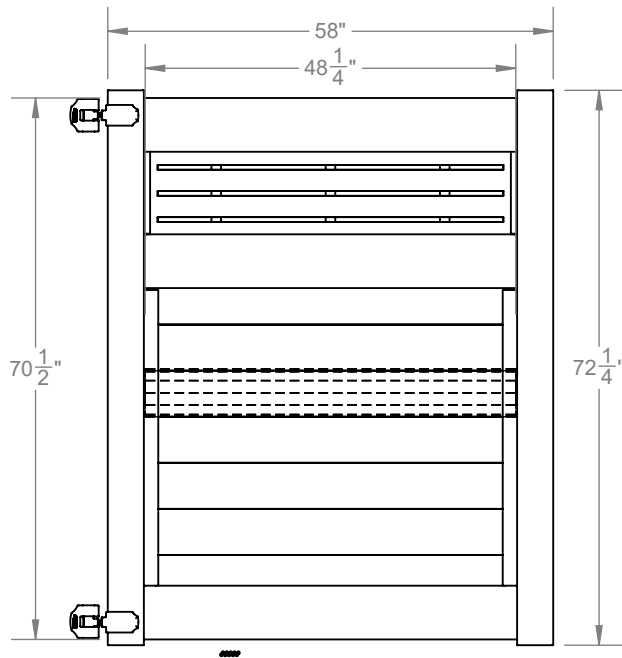

NOTES:  
1. VERIFY GLIDELOCK  
COVERS ARE INSTALLED  
AND GLUED TO UPRIGHT  
PRIOR TO PACKAGING KIT.

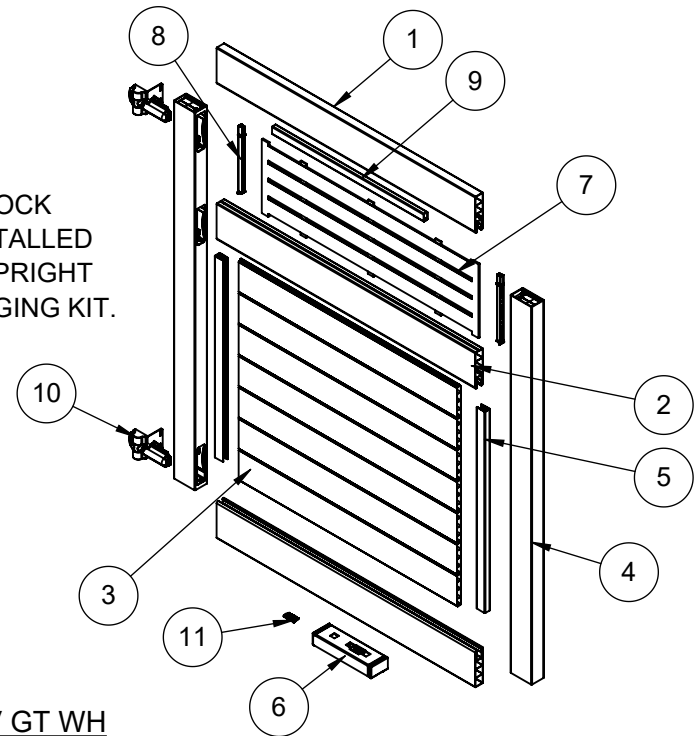

6X58 1.75x7 HZL DSP TOP PRIV GT WH